

PUSH BUTTON SWITCH



Series
TS



Our Push Button Switch (TS) is available in reliable KISSLING quality in 1-pole and 2-pole version with change-over function. These switch types are suited for various mounting conditions and thus meet your individual requirements. The push button itself is available in various colours, with symbols and also in an illuminated version.

The push button switch is especially characterized by its seal level IP67 & IP6K9K as well as its high shock and vibration resistance. For this reason, it is highly suitable for performance under demanding environmental conditions.

Typical applications:

- Plant and industrial engineering
- Commercial vehicles
- Special suitability as system start/stop switch in various kinds of mobile applications and in control panels also with remote control function

Dimensions

Housing Socket

1

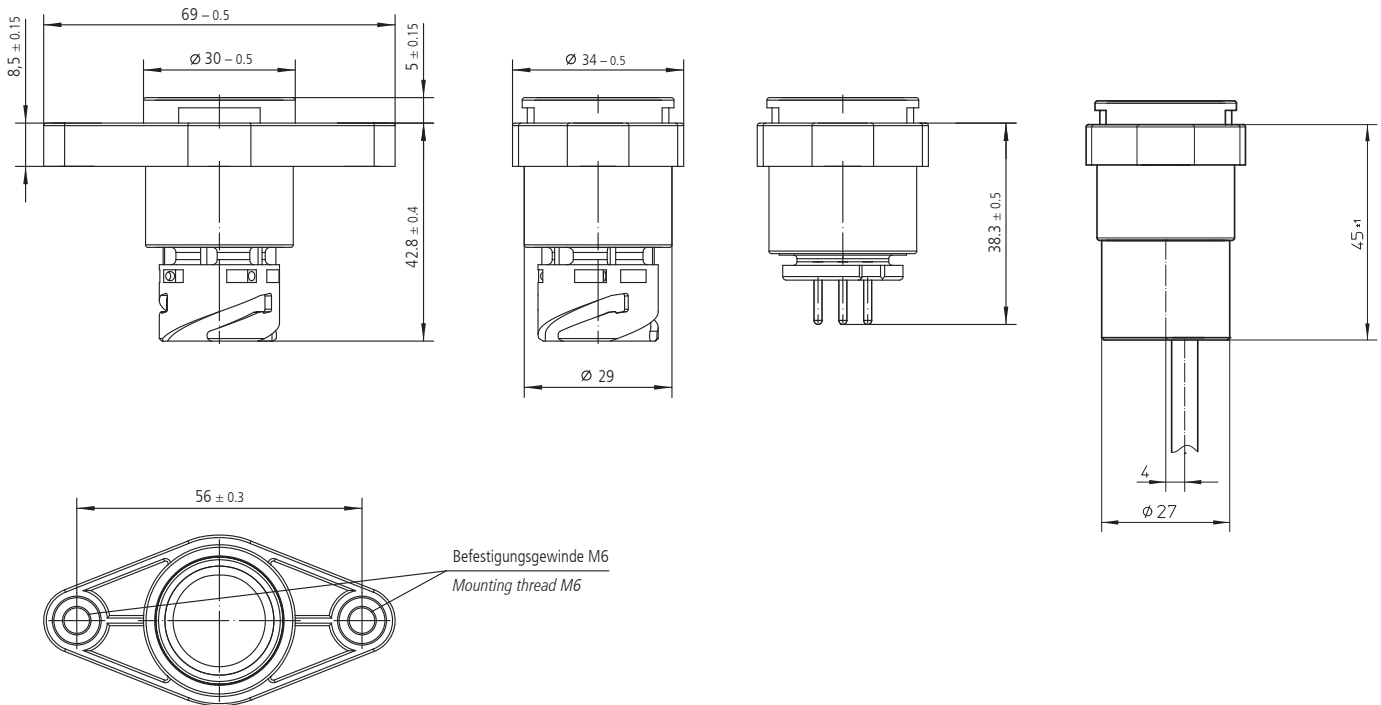

Socket Central thread

2

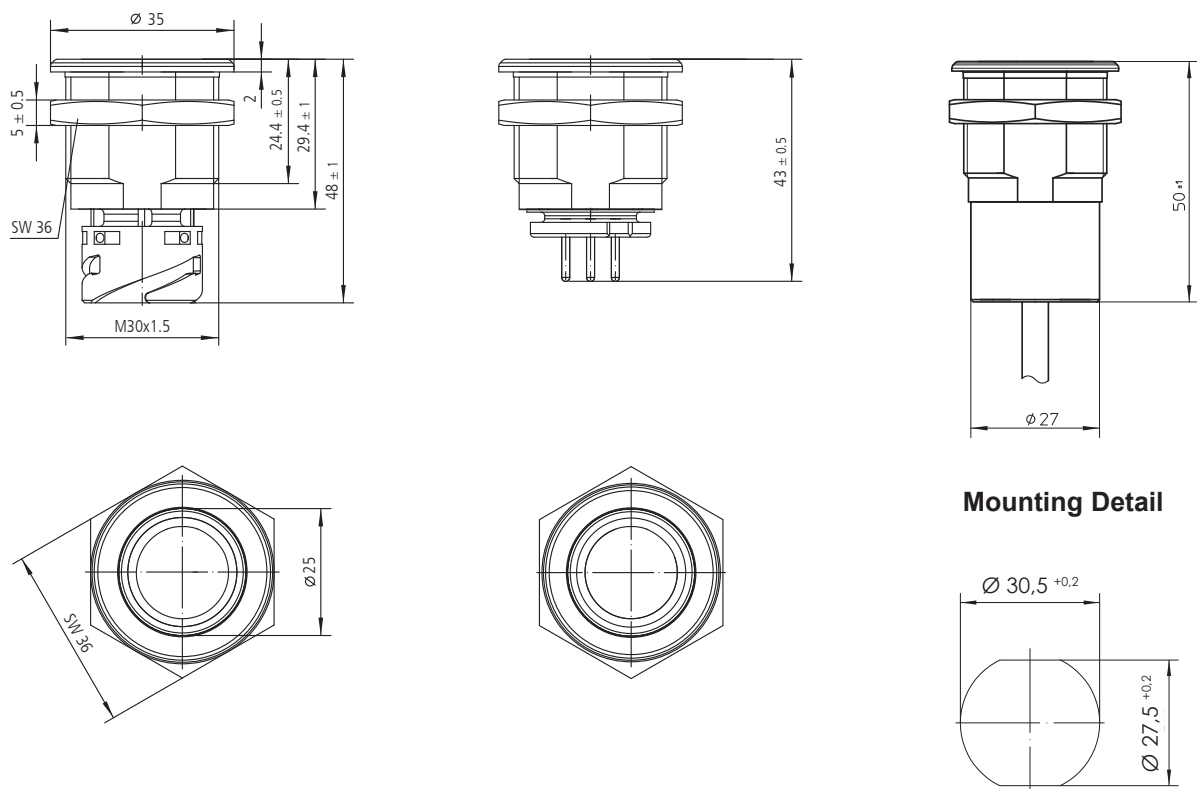

Switching function

Indicator Light

0



Change-over 1-pole

1

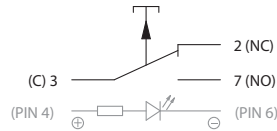

Change-over 2-pole

2

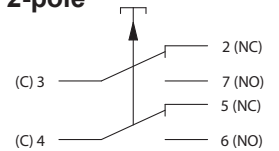

Connector

Plug and socket device DIN 72585/ ISO 15170-A1-2.1-Ag/K1

1

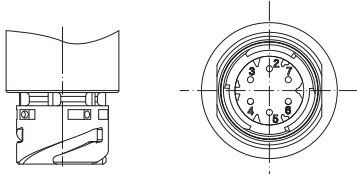

Solder Connection

2

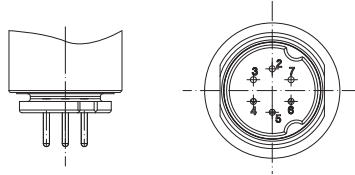

Cable Connection

3

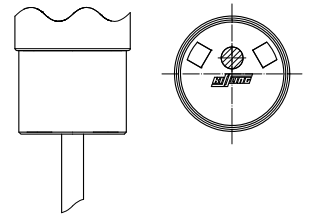

Actuator Symbol

Without print

1

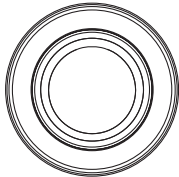

Battery

2

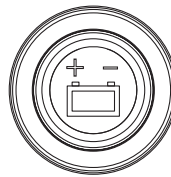

START

3

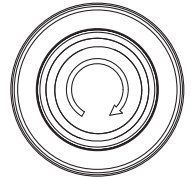

STOP

4



Lamp

5

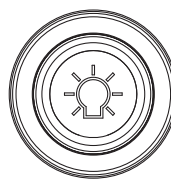

Motor

6

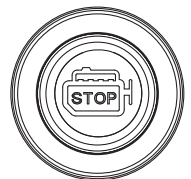

Other types and special types upon request

Ordering Key

TS. 2 1 2 . RT 5 1

1 2 3 4 5 6 7

Example

TS.212.RT51

1	Series
2	Housing
3	Switching function
4	Connector
5	Actuator colour (additional colour on request)
	RT red
	BL blue
	SW black
	GE yellow
	GN green
6	Actuator symbol
7	Lighting
	1 without
	2 with (only possible with 1-pole-switch)

Technical Data

Environmental Characteristics

Material housing	PA
Material Actuator	PMMA
Protection	IEC 60529, IP67& IP6K9K
Temperature range	-40°F to +194°F
Material terminals	CuZn
Mounting positions	optional

Max. torque

Thread sizes	M30 = max 5 Nm / M6 = 10 Nm
--------------	-----------------------------

Mechanical Data (Change-Over)

Pre-travel	1,5 ± 0.5 mm
Contact travel	2,5 + 0,5 mm
Operating force	max 40 N
Current carrying parts	Cu-alloy
Contact material	Ag-alloy
Mechanical life	100 000 cycles
Frequency	max. 100/min

Electrical Data

Voltage range	9 VDC - 32 VDC
Resistive load	10 mA to 5A

Other types and special types upon request



KISSLING Electrotec Inc.
 320 Business Parkway, Suite A
 Greer, SC 29651-7114
 Phone: 864-848-9766
 Fax: 864-848-9767
 E-mail: info@kissling.us
 Internet: www.kissling.us