

Power Conversion

SELECTOR GUIDE

APPLICATIONS:

- HV battery
- E-motor
- AC / DC inverter
- Power electric box
- Distribution Unit (HV PDU)
- DC / DC converter



Application	AC / DC inverter, DC / DC converter, HV battery, Power electric box, HV PDU				E-motor, AC / DC inverter, Power electric box, HV PDU
Description	SHIELD-PACK™ AK CLASS 4	HV RCS 890 SW SERIES	HV RCS 800 SERIES	HV RCS 890 SERIES	HV RCS 890 RV 2 WAY SERIES
Amperage at 85°C	245 A	210 A	210 A	200 A	200 A
Voltage	1000 V	600 V	1000 V	1000 V	1000 V
Orientation	90° 180°	90°	180°	90°	90°
# of ways (power)	2	2	2	2	2
HVIL	✓	✓	✓	✓	✓
Shielding	Individual	Individual	Bundle	Bundle	Bundle
Vibration Class	V2	V1*	V1	V1	V1
Temperature Class	T4	T3	T3	T3	T3
Sections power	25 - 50 mm²	35 - 70 mm²	35 - 50 mm²	35 - 50 mm²	16 - 70 mm²
Sections HVIL	0.5 mm²	0.35 - 1.0 mm²	0.5 - 0.75 mm²	0.5 - 0.75 mm²	0.5 - 0.75 mm²
See Page	34-35	36-37	38-39	40-41	42-43

* For classification V2 please consult an Aptiv representative.

** For solution with HVIL please contact your local Aptiv representative.



AC / DC inverter, DC / DC converter, HV battery, Power electric box, HV PDU					AC / DC inverter, HV battery, HV PDU, Power electric box, E-motor	
HV RCS 890 RV 3 WAY SERIES	HV RCS 800 DIRECT MATE 1 WAY	HV RCS 800 DIRECT MATE 2 WAY	HV RCS 890 DIRECT MATE 2 WAY	SHIELD-PACK™ HV2000	HV AK PASS-THROUGH	HV METAL PASS-THROUGH
200 A	210 A	210 A	200 A	250 A	N/A	N/A
1000 V	850 V	850 V	850 V	1000 V	600 V (AC) 1000 V (DC)	600 V (AC) 1000 V (DC)
90°	180°	180°	90°	90°	180°	180°
3	1	2	2	2	1, 2 & 3	1
✓	×	×**	✓	✓	×	×
Bundle	Unshielded	Individual	Individual	Individual	Individual	Individual
V1	V1*	V1*	V1*	V3	V4	V3
T3	T3	T3	T3	T3	T4	T3
16 - 70 mm²	35 - 50 mm²	35 - 50 mm²	35 - 50 mm²	35 - 50 mm²	16 - 50 mm²	25 - 50 mm²
0.5 - 0.75 mm²	—	—	0.35 - 1.0 mm²	0.5 mm²	—	—
44-45	46-47	48-49	50-51	52-53	54-55	56-57



SHIELD-PACK™ AK CLASS 4 AK



BENEFITS

- Standard AK interface
- High robustness against vibrations
- Higher operating temperatures

FEATURES

- Header compatible with both straight & right angle female connector
- Connector and header design according to AK interface specification and LV215 latest revision
- Individual shielded cables
- Fully compatible with other AK supplier sources

APPLICATIONS

AC / DC inverter

HV battery

HV PDU

E-motor

Power electric box

AVAILABLE CONFIGURATIONS

Connector Type	Wire-to-device
Cable Exit Orientation	90°, 180°
Cable Range (mm²)	25 - 50 (power) 0.5 (HVIL)
Terminal Type	8 mm round contact system
# of Power Terminals	2
Shielding	Individual
HVIL	Shunt on female
Assembly Assurance	CPA/TPA
Number of Indexes	4

PERFORMANCE

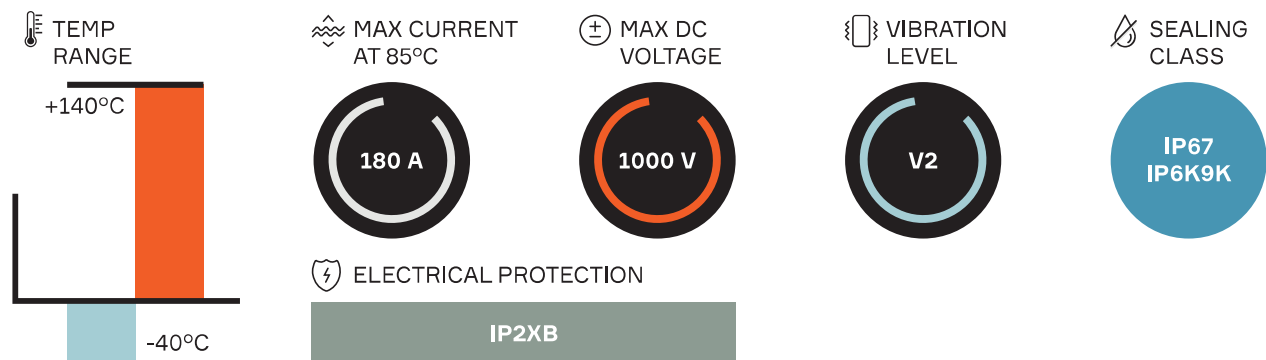

Code	Header UL HB	Header UL VO	2 way mating outer housing	BOM
A	35166503	33351454	33355781	1
B	35166504	33351455	33355782	
C	35166505	-	33355783	
D	35166506	-	33355784	

ASSOCIATED PARTS

Description	Cable size			BOM*
	25 mm ²	35 mm ²	50 mm ²	
Outer insulation	35172730			2
Active female terminal	35172744			2
Crimp female terminal	35172741	35172742		2
Inner ferrule	35172724	35172725	35172726	2
Outer ferrule - Ni plated	35172727	35172728	35172729	2
Cable strain relief	35172735	35172736	35172737	2
Cable seal	35172732	35172733	35172734	2
HVIL 1.2 male terminal MCON* 0.5 mm ²	13954415			3
HVIL 1.2 male terminal MCON* 0.75 mm ²	13952636			3

* Reference refers to external supplier.

Component Kits**

Part number	Code	Part number	Code	Part number	Code
Assembly for 25 mm² cable		Assembly for 35 mm² cable		Assembly for 50 mm² cable	
35039798	A	35039802	A	35039808	A
35039799	B	35039804	B	35039809	B
35039800	C	35039805	C	35039810	C
35039801	D	35039806	D	35039811	D

** Available configurations with associated BOM (Bill Of Materials).

DIMENSION MEASUREMENT SAMPLE

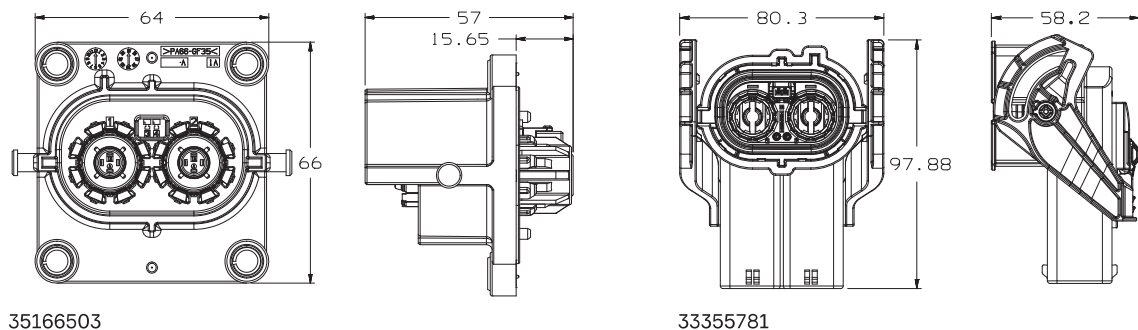

Part numbers, specifications, dimensions and performance data in this document are for general references only and are subject to change without notice. To verify product information, please contact an Aptiv representative.



HV RCS 890 SW SERIES



BENEFITS

- Specifically designed for compact environments
- High-water protections resulting from sealed unmated header
- Easy assembly thanks to slider feature on female connector

FEATURES

- Header has flat and simple device interface
- Connectors dismounting in 2 steps for time delay between interlock opening and power disconnection
- Slider solution offers the maximum pressure surface in limited space conditions

APPLICATIONS

AC / DC inverter

DC / DC converter

HV battery

Power electric box

HV PDU

AVAILABLE CONFIGURATIONS

Connector Type	Wire-to-device
Cable Exit Orientation	90°
Cable Range (mm²)	35 - 70
Terminal Type	8 mm round contact system
# of Power Terminals	2
Shielding	Individual
HVIL	Shunt on female
Assembly Assurance	CPA
Number of Indexes	1

PERFORMANCE

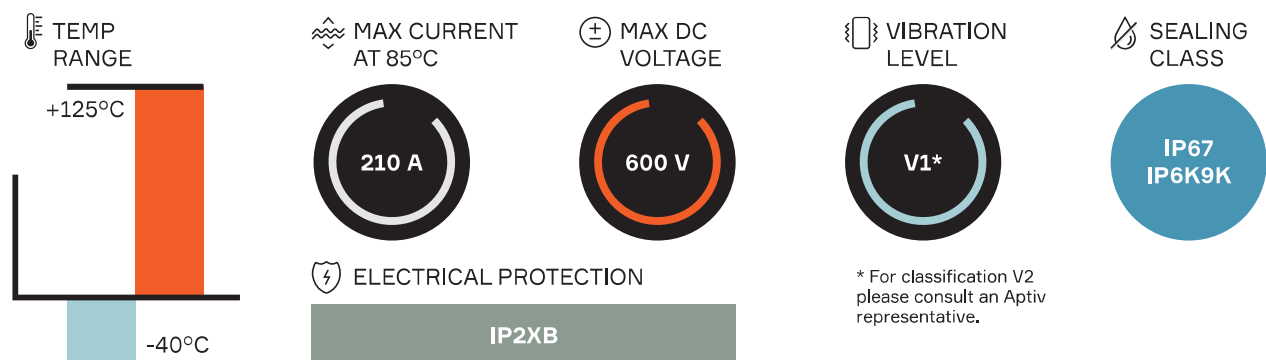

Header connector	Mating connector	BOM
35254402	35254366	1

ASSOCIATED PARTS

Part number	Description	BOM
Header		
15549847	DSQ 1.5 female terminal silver-plated 0.35 - 0.50 mm²	2
15549848	DSQ 1.5 female terminal silver-plated 0.75 - 1.00 mm²	
15441379	DCS/DSQ 1.5 male red single wire seal 0.22 - 0.5 mm²	2
15441380	DCS/DSQ 1.5 male grey single wire seal 0.75 - 1.0 mm²	
Mating Connector		
33502217	RCS890 female terminal silver-plated 35 - 50 mm²	2
35166051	RCS890 female terminal silver-plated 70 mm²	
35082415	Outer ferrule 35 mm²	2
35234890	Outer ferrule 50 - 70 mm²	
35084603	Recovery shield assembly 35 mm²	2
35236787	Recovery shield assembly 50 - 70 mm²	
35084610	Single wire seal & retainer 35 mm²	2
35084586	Single wire seal & retainer 50 mm²	
35236755	Single wire seal & retainer 70 mm²	

DIMENSION MEASUREMENT SAMPLE

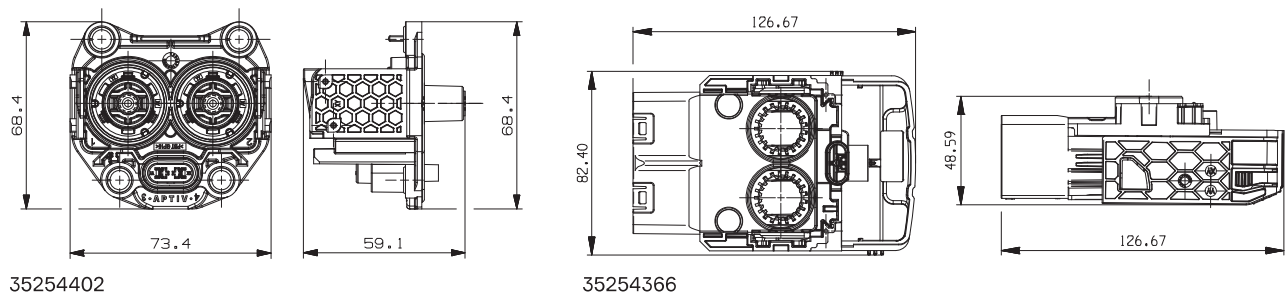

HV RCS 800 SERIES



BENEFITS

- Easy to assemble with integrated ErgoMate™ Axial Mating Assist System on harness connector
- Compact package with unique integrated electric interlock
- Header is sealed in both mated and unmated positions

FEATURES

- Bundle shielding with external braid
- Panel mount to device with face seal to module
- Two-stage disconnect for safe unmating

APPLICATIONS

AC / DC inverter

DC / DC converter

HV battery

Power electric box

HV PDU

AVAILABLE CONFIGURATIONS

Connector Type	Wire-to-device
Cable Exit Orientation	180°
Cable Range (mm ²)	35 - 50 (power) 0.5 - 0.75 (HVIL)
Terminal Type	8 mm round contact system
# of Power Terminals	2
Shielding	Bundle
HVIL	Shunt on female
Assembly Assurance	CPA
Number of Indexes	2

PERFORMANCE

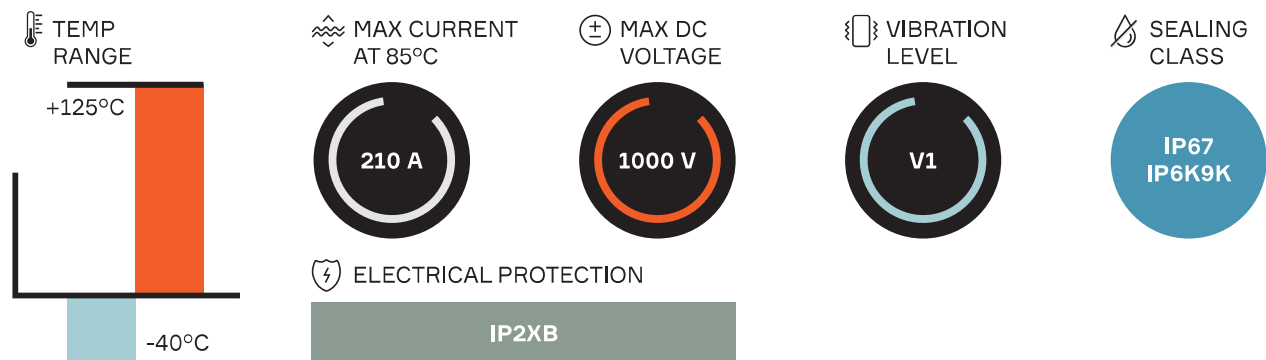

Index	Header connector	Mating connector	BOM
1	33511764	13974469	1
2	33511762	33511761	

ASSOCIATED PARTS

Part number	Description	BOM
Header		
33512193	RCS 800/890 male pin terminal silver version standard length	2
33511746	RCS 800/890 male pin terminal silver version V1 length	
33511747	RCS 800/890 male pin terminal silver version V2 length	
10779703	DCS2 1.5 male terminal gold-plated 0.5 - 1.0 mm²	2
15441379	DCS/DSQ 1.5 red single wire seal 0.22 - 0.5 mm²	2
15441380	DCS/DSQ 1.5 grey single wire seal 0.75 - 1.0 mm²	
Mating Connector		
13893887	RCS 800 female terminal silver version 35 - 50 mm²	2
13893889	RCS 800 female retainer (plug)	2
13893888	RCS 800 female 35 - 40 mm² (plug)	2
13923559	RCS 800 female 50 mm² (plug)	

DIMENSION MEASUREMENT SAMPLE

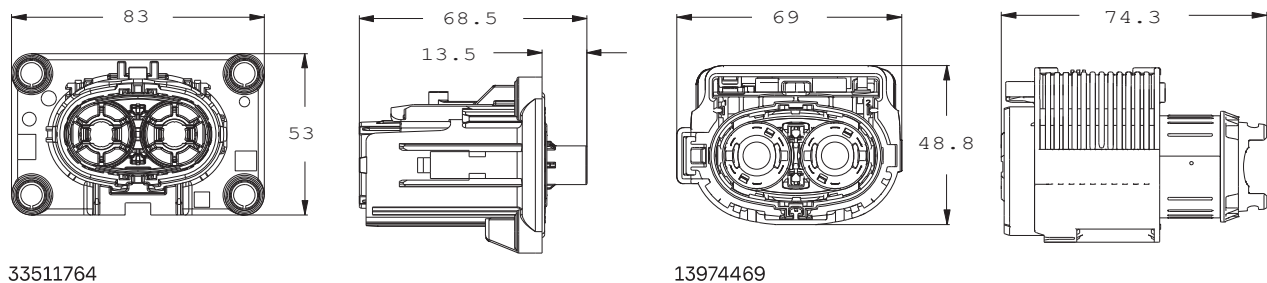



HV RCS 890 SERIES

FOR NEW DESIGN, CONSIDER THE NEW HV 890 RV SERIES



BENEFITS

- Easy to assemble with integrated ErgoMate™ Axial Mating Assist System on harness connector
- Compact package with unique integrated electric interlock
- Header is sealed in both mated and unmated position

FEATURES

- Bundle shielding with external braid
- Panel mount to device with face seal to module
- Two-stage disconnect for safe unmating

APPLICATIONS

AC / DC inverter

DC / DC converter

HV battery

Power electric box

HV PDU

AVAILABLE CONFIGURATIONS

Connector Type	Wire-to-device
Cable Exit Orientation	90°
Cable Range (mm ²)	35 - 50 (power) 0.5 - 0.75 (HVIL)
Terminal Type	8 mm round contact system
# of Power Terminals	2
Shielding	Bundle
HVIL	Shunt on female
Assembly Assurance	CPA
Number of Indexes	1

PERFORMANCE

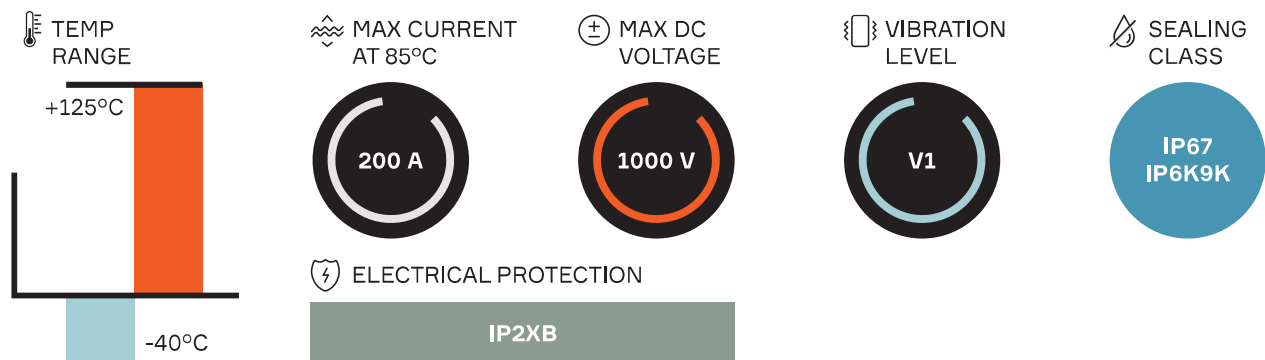

Header connector	Mating connector	BOM
33503821	33511750	1

ASSOCIATED PARTS

Part number	Description	BOM
Header		
33512193	RCS 800/890 male pin terminal silver version standard length	2
33511746	RCS 800/890 male pin terminal silver version V1 length	
33511747	RCS 800/890 male pin terminal silver version V2 length	
10811962	DCS2 1.5 female terminal gold-plated 0.5 - 1.0 mm²	2
15441379	DCS/DSQ 1.5 red single wire seal 0.22 - 0.5 mm²	2
15441380	DCS/DSQ 1.5 grey single wire seal 0.75 - 1.0 mm²	
Mating Connector		
33511752	RCS 890 female terminal silver version 16 - 25 mm²	2
33502217	RCS 890 female terminal silver version 35 - 50 mm²	
35166051	RCS 890 female terminal silver version 70 mm²	
33521619	RCS 890 single wire seal & retainer 16-25 mm²	2
33511753	RCS 890 single wire seal & retainer 35 - 40 mm²	
33511754	RCS 890 single wire seal & retainer 50 mm²	
35199856	RCS 890 single wire seal & retainer 70 mm²	
33504038	RCS 890 2-way half clamp	2

DIMENSION MEASUREMENT SAMPLE

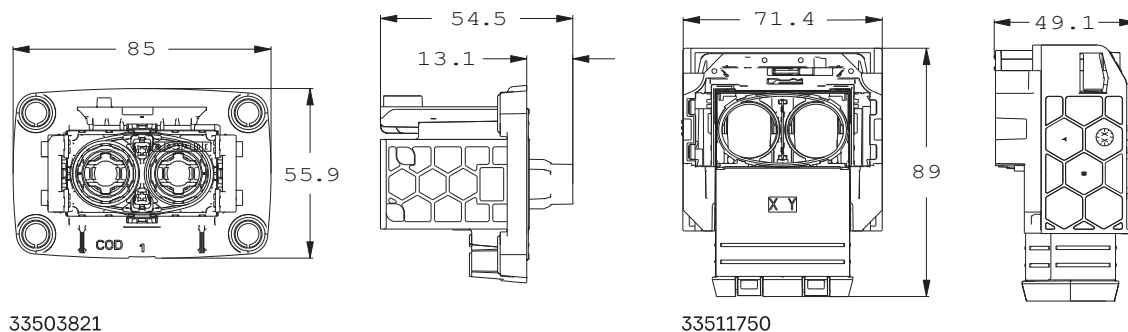

HV RCS 890 RV 2 WAY SERIES

USE FOR NEW DESIGN



BENEFITS

- Ultra compact design for applications with space constraints
- Panel mount to device with face seal to module
- Header is sealed in both mated and unmated position

FEATURES

- Two-stage disconnect for safe unmating
- Easier mating with Slider Mating Assist System on harness connector
- Bundle shielding with external braid
- HVIL shunted in harness connector

APPLICATIONS

AC / DC inverter

DC / DC converter

HV battery

Power electric box

HV PDU

AVAILABLE CONFIGURATIONS

Connector Type	Wire-to-device
Cable Exit Orientation	90°
Cable Range (mm ²)	16 - 70 (power) 0.35 - 1.0 (HVIL)
Terminal Type	8 mm round contact system
# of Power Terminals	2
Shielding	Bundle
HVIL	Shunt on female
Assembly Assurance	CPA
Number of Indexes	2

PERFORMANCE

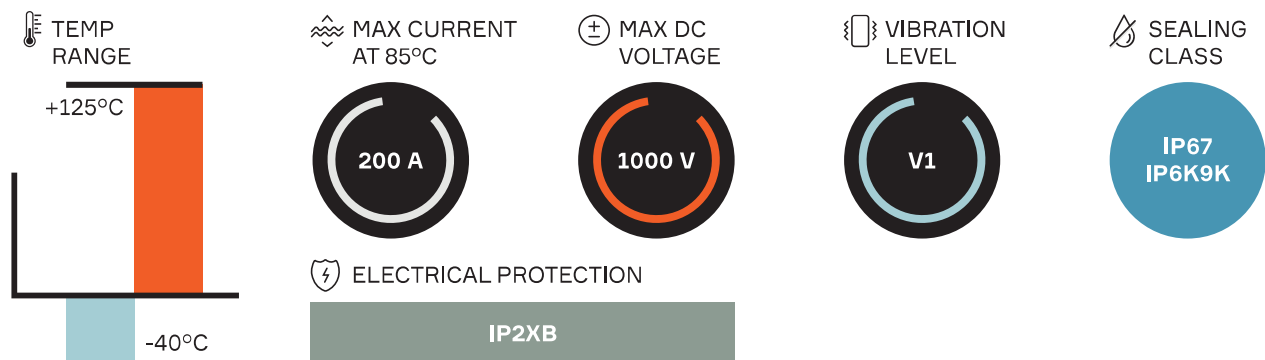

Index	Header connector	Mating connector	BOM
1	35326611	35092244	1
2	35326613	35092239	

ASSOCIATED PARTS

Part number	Description	BOM
Header		
10811962	DCS2 1.5 female terminal gold-plated 0.5 - 1.0 mm ²	2
15441379	DCS/DSQ 1.5 red single wire seal 0.35 - 0.5 mm ²	2
15441380	DCS/DSQ 1.5 grey single wire seal 0.75 - 1.0 mm ²	
33273083	RCS 800 male bus bar terminal silver version polarized pin	2
Mating Connector		
33511752	RCS 890 female terminal silver version 16 - 25 mm ²	2
33502217	RCS 890 female terminal silver version 35 - 50 mm ²	
35166051	RCS 890 female terminal silver version 70 mm ²	
33521619	RCS 890 single wire seal & retainer (plug) 16 - 25 mm ²	2
33511753	RCS 890 2-way female single wire seal & retainer (plug) 35 - 40 mm ²	
33511754	RCS 890 2-way female single wire seal & retainer (plug) 50 mm ²	
35199856	RCS 890 2-way female single wire seal & retainer (plug) 70 mm ²	
35091447	RCS 890 2-way half clamp	2

DIMENSION MEASUREMENT SAMPLE

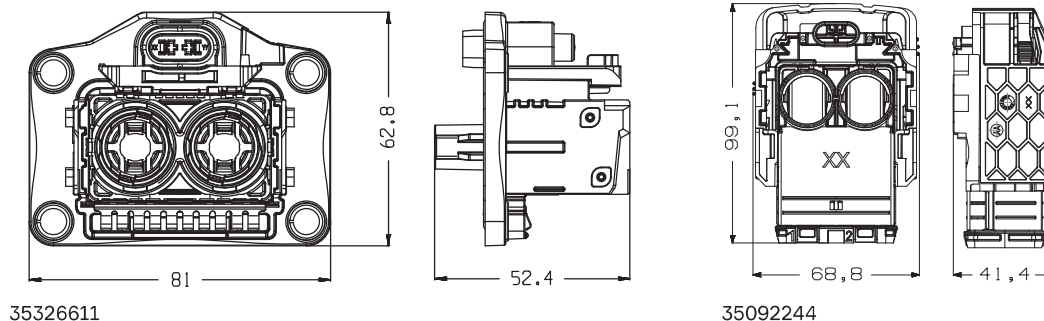

HV RCS 890 RV 3 WAY SERIES



BENEFITS

- Ultra compact design for applications with space constraints
- Panel mount to device with face seal to module
- Header is sealed in both mated and unmated position

FEATURES

- Two-stage disconnect for safe unmating
- Easier mating with Slider Mating Assist System on harness connector
- Bundle shielding with external braid
- HVIL shunted in harness connector

APPLICATIONS

AC / DC inverter

DC / DC converter

HV battery

Power electric box

HV PDU

AVAILABLE CONFIGURATIONS

Connector Type	Wire-to-device
Cable Exit Orientation	90°
Cable Range (mm ²)	16 - 70 (power) 0.5 - 0.75 (HVIL)
Terminal Type	8 mm round contact system
# of Power Terminals	3
Shielding	Bundle
HVIL	Shunt on female
Assembly Assurance	CPA
Number of Indexes	2

PERFORMANCE

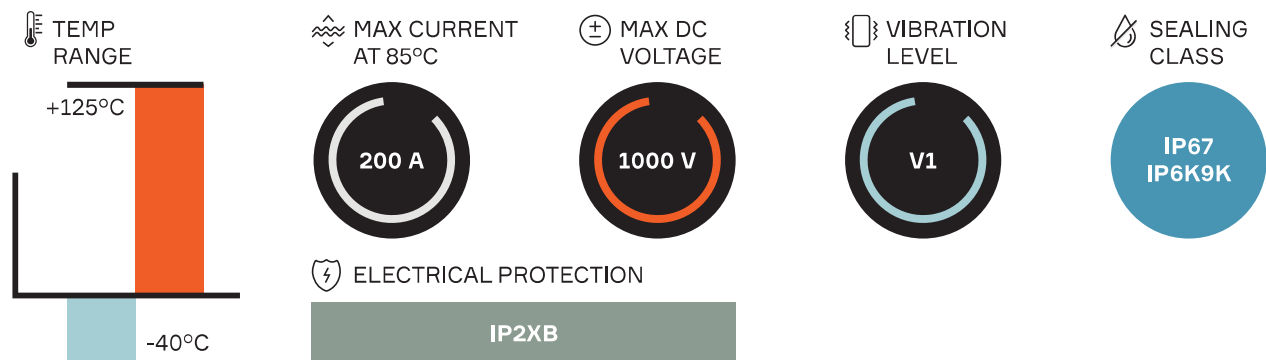

Index	Header connector	Mating connector	BOM
1	35310180	33272670	1
2	35310181	33282936	

ASSOCIATED PARTS

Part number	Description	BOM
Header		
33273083	RCS 800 male bus bar terminal silver version polarized pin	3
10811962	DCS2 1.5 female terminal gold-plated 0.5 - 1.0 mm²	2
15441379	DCS/DSQ 1.5 red single wire seal 0.35 - 0.5 mm²	2
15441380	DCS/DSQ 1.5 grey single wire seal 0.75 - 1.0 mm²	
Mating Connector		
33511752	RCS 890 female terminal silver version 16 - 25 mm²	3
33502217	RCS 890 female terminal silver version 35 - 50 mm²	
35166051	RCS 890 female terminal silver version 70 mm²	
33521619	RCS 890 single wire seal & retainer 16 - 25 mm²	3
33511753	RCS 890 single wire seal & retainer 35 - 40 mm²	
33511754	RCS 890 single wire seal & retainer 50 mm²	
35199856	RCS 890 single wire seal & retainer 70 mm²	
33272561	RCS 890 3-way half clamp	2

DIMENSION MEASUREMENT SAMPLE

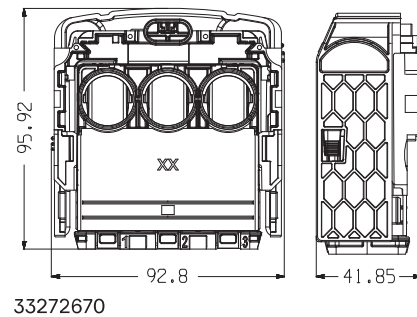
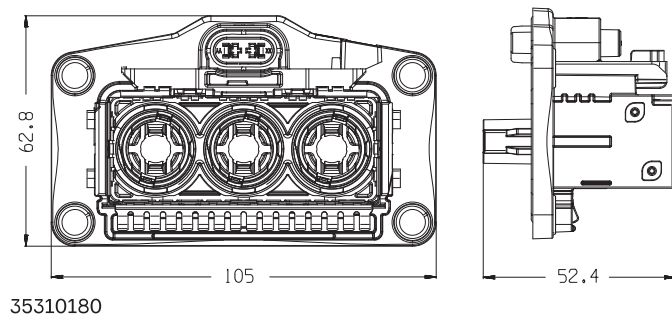



HV RCS 800

DIRECT MATE 1 WAY



BENEFITS

- Cost effective thanks to the direct connection between the female connector and the male terminals within the device case
- Unique and safe mating screwing with innovative Screw Position Assurance (SPA)
- Versatile solution covering multiple applications: high voltage power conversion and 48 volt

FEATURES

- Robust bolt driven mate assist
- Fingersafe via plastic tips on male pins
- Unshielded connector system

APPLICATIONS

AC / DC inverter

DC / DC converter

HV battery

Power electric box

HV PDU

AVAILABLE CONFIGURATIONS

Connector Type	Wire-to-device
Cable Exit Orientation	180°
Cable Range (mm ²)	35 - 50 (power)
Terminal Type	8 mm round contact system
# of Power Terminals	1
Shielding	None
HVIL	None
Assembly Assurance	SPA
Number of Indexes	1

PERFORMANCE

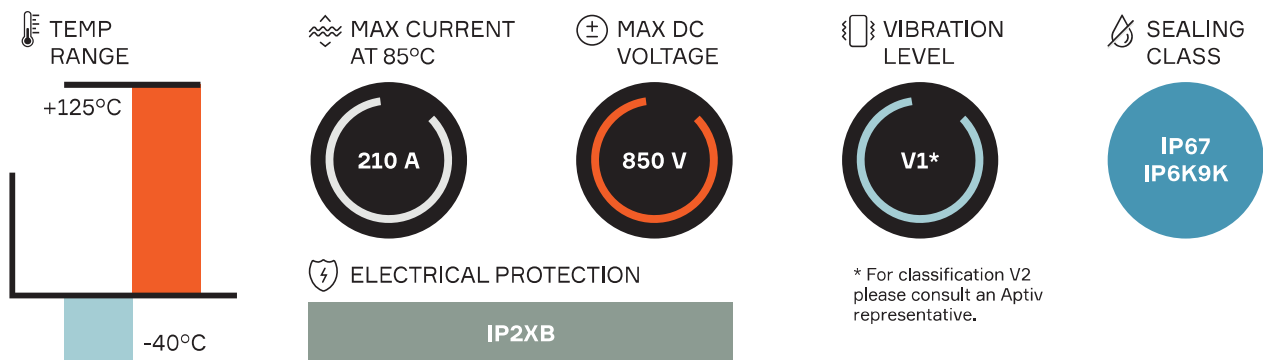

Header connector*	Mating connector	BOM
35098440	35098437	1

* Header connector is a fully assembled part and therefore has no associated parts.

ASSOCIATED PARTS

Part number	Description	BOM
Mating Connector		
13893887	RCS 800 female terminal 35 - 50 mm ²	1
13893888	Female black single wire seal 35 mm ²	1
13923559	Female grey single wire seal 50 mm ²	
13893889	Retainer	1

DIMENSION MEASUREMENT SAMPLE

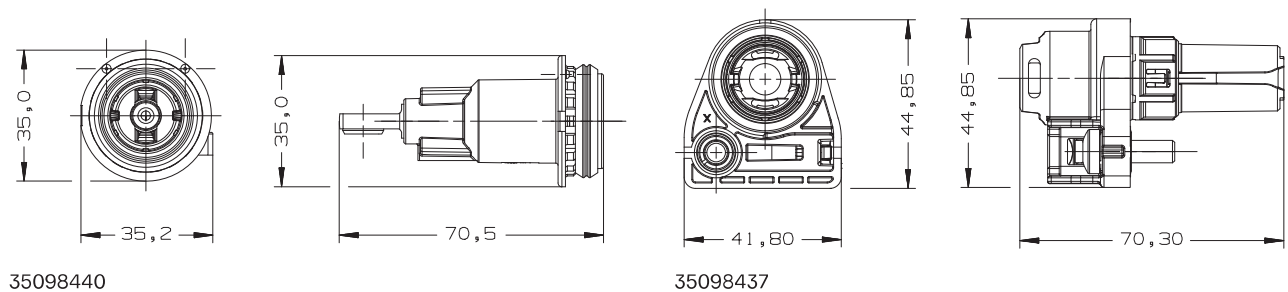



HV RCS 800

DIRECT MATE 2 WAY

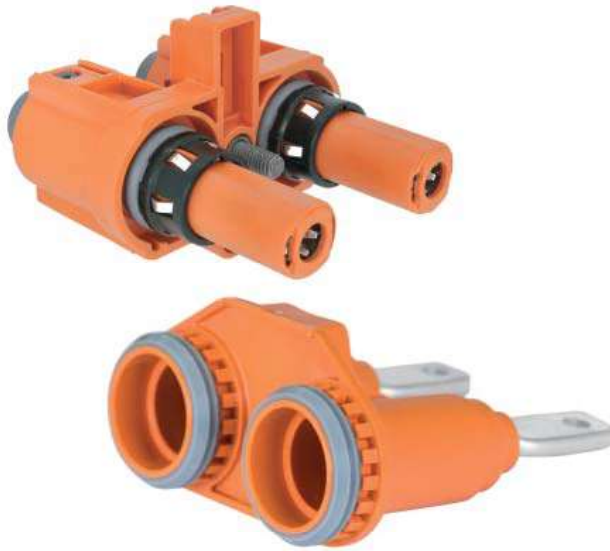

BENEFITS

- Cost effective solution with unshielded terminal holder within device replacing traditional shielded headers
- Unique and safe mating screwing with innovative Screw Position Assurance (SPA)
- Header is sealed in both mated and unmated position

FEATURES

- Robust bolt driven mate assist
- Fingersafe via plastic tips on male pins
- Cable range: ~ 50 mm² and smaller

APPLICATIONS

AC / DC inverter

DC / DC converter

HV battery

Power electric box

HV PDU

AVAILABLE CONFIGURATIONS

Connector Type	Wire-to-device
Cable Exit Orientation	180°
Cable Range (mm ²)	35 - 50 (power) 0.35 - 1.0 (HVIL)
Terminal Type	8 mm round contact system
# of Power Terminals	2
Shielding	Individual
HVIL	Shunt on female
Assembly Assurance	SPA
Number of Indexes	1

PERFORMANCE

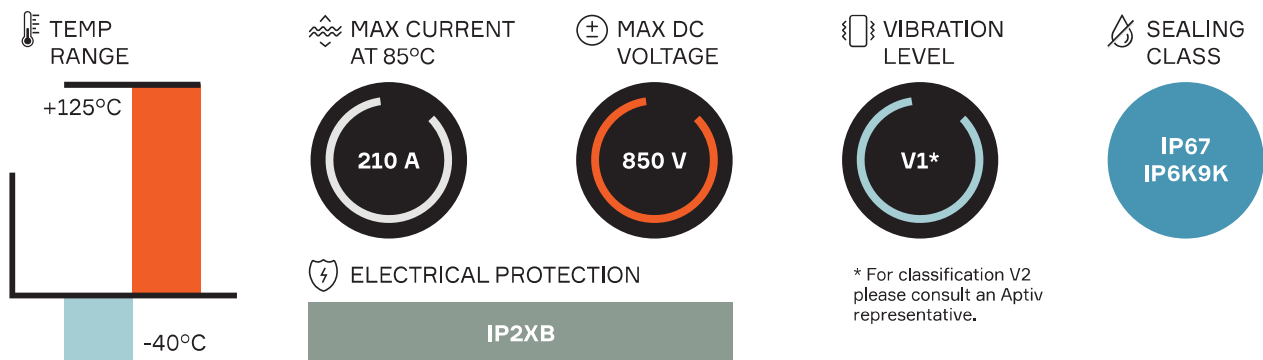

Header*	Header with HVIL**	Mating connector	BOM
35099885	35099880	35098453	1

* Header connector is a fully assembled part and therefore has no associated parts.
** Please contact your local Aptiv representative for serial production information.

ASSOCIATED PARTS

Part number	Description	BOM
Mating connector		
13893887	RCS 800 female terminal silver-plated 35 - 50 mm²	2
35082410	Inner ferrule 35 and 50 mm²	2
35082415	Outer ferrule 35 and 50 mm²	2
35099247	Single wire seal & retainer 35 mm²	2
35099248***	Single wire seal & retainer 50 mm²	
35092416	RCS800 tube 35 - 50 mm²	2

*** Available only by prototype, please contact your local Aptiv representative for more information on serial production.

DIMENSION MEASUREMENT SAMPLE

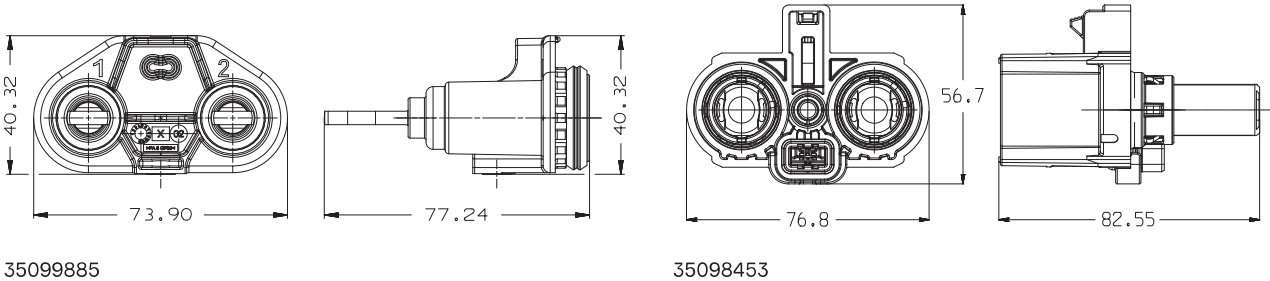



HV RCS 890

DIRECT MATE 2 WAY



BENEFITS

- Cost effective solution with unshielded terminal holder within device replacing traditional shielded headers
- Unique and safe mating screwing with innovative Screw Position Assurance (SPA)
- Header is sealed in both mated and unmated position

FEATURES

- Robust bolt driven mate assist
- Fingersafe via plastic tips on male pins
- Cable range: ~ 50 mm² and smaller

APPLICATIONS

AC / DC inverter

DC / DC converter

HV battery

Power electric box

HV PDU

AVAILABLE CONFIGURATIONS

Connector Type	Wire-to-device
Cable Exit Orientation	90°
Cable Range (mm ²)	35 - 50 (power) 0.35 - 1.0 (HVIL)
Terminal Type	8 mm round contact system
# of Power Terminals	2
Shielding	Individual
HVIL	Shunt on female
Assembly Assurance	SPA (Screwed Position Assurance)
Number of Indexes	1

PERFORMANCE

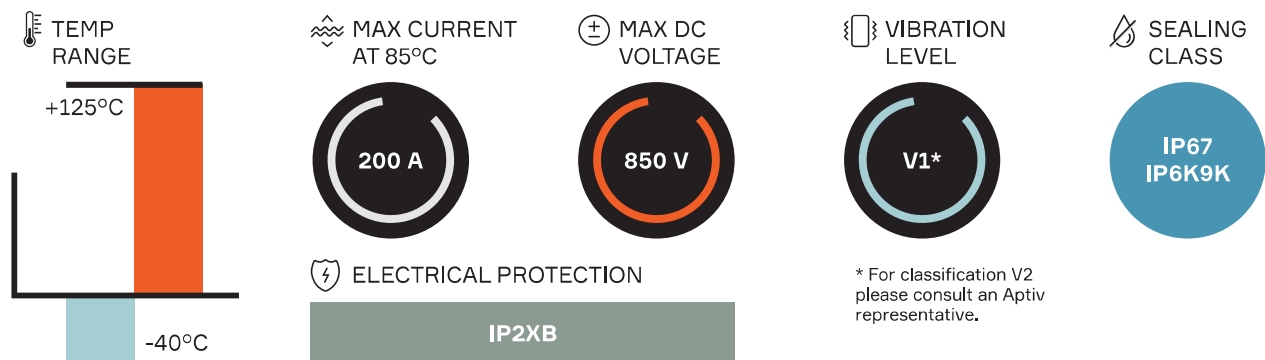

Header	Mating connector	BOM
35084594	35084575	1

ASSOCIATED PARTS

Part number	Description	BOM
Header		
15549847	DSQ 1.5 female terminal silver-plated 0.35 - 0.50 mm²	2
15549848	DSQ 1.5 female terminal silver-plated 0.75 - 1.00 mm²	
15441379	DCS/DSQ 1.5 red single wire seal 0.22 - 0.5 mm²	2
15441380	DCS/DSQ 1.5 grey single wire seal 0.75 - 1.0 mm²	
Mating connector		
33502217	RCS 890 female terminal silver-plated 35 - 50 mm²	2
35082415	Outer ferrule 35 mm²	2
35234890	Outer ferrule 50 mm²	
35084603	Recovery shield assembly 35 mm²	2
35236787	Recovery shield assembly 50 mm²	
35084610	Single wire seal & retainer 35 mm²	2
35084586	Single wire seal & retainer 50 mm²	

DIMENSION MEASUREMENT SAMPLE

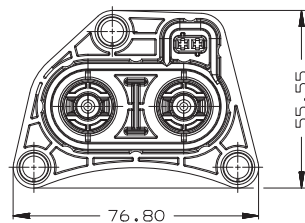

35084594

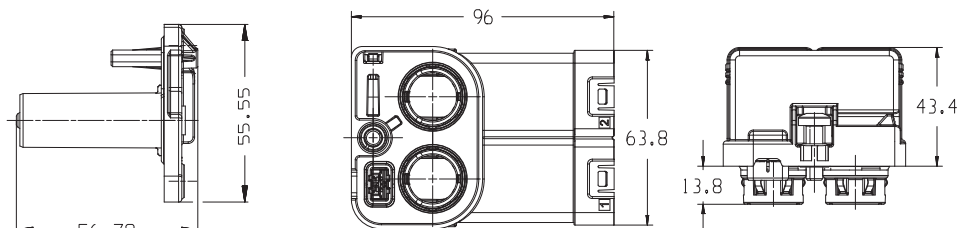

35084575

SHIELD-PACK™ HV2000



BENEFITS

- Header interface is integrated into device case
- Cost-effective full plastic header assembled from inside out
- Bolt driven mate assist
- Ultrasonic welding used for power terminal

FEATURES

- Internal HVIL shunted in harness connector
- Finger proof and non-finger proof options available
- Provides finger proof terminal towers and HVIL
- Header accepts busbars provided by module

APPLICATIONS

AC / DC inverter

DC / DC converter

HV battery

Power electric box

HV PDU

AVAILABLE CONFIGURATIONS

Connector Type	Wire-to-device
Cable Exit Orientation	90°
Cable Range (mm ²)	35 - 50 (power) 0.5 (HVIL)
Terminal Type	Power Pack 2000 17.7
# of Terminals	2
Shielding Type	Individual
HVIL	Shunt on female
Assembly Assurance	CPA/TPA
Number of Indexes	1

PERFORMANCE

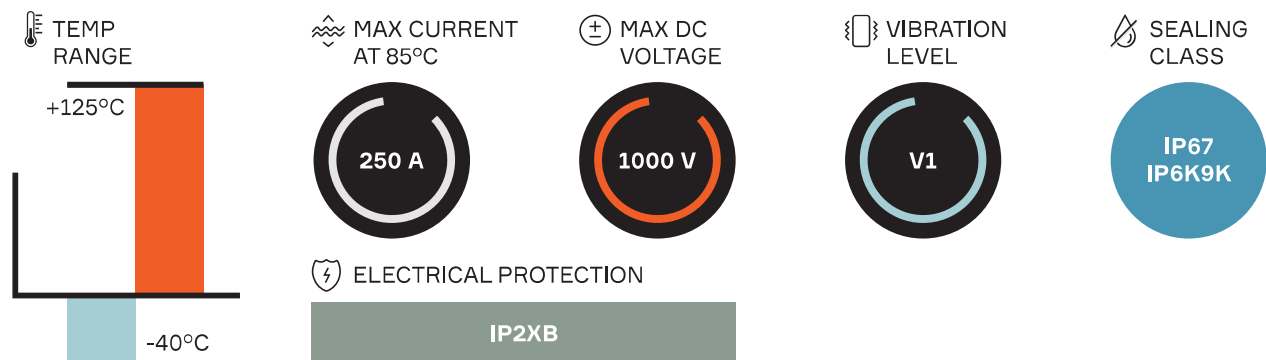

Header connector	Mating connector	BOM
33346375	33352038	1

ASSOCIATED PARTS

Part number	Description	BOM
Header		
15432237	CTS female terminal silver-plated HVIL 0,35 mm ²	2
33346276	HVIL TPA	1
Mating Connector		
13801592	Power Pack 2000 female sonic weld terminal	2
33352058	Inner ferrule 35 mm ²	2
33352059	Inner ferrule 50 mm ²	2
33352056	Outer ferrule 35 mm ² & 50 mm ²	2
33352048	Cable seal 35 mm ²	2
33352049	Cable seal 50 mm ²	2
33352051	Strain relief 35 mm ²	2
33352052	Strain relief 50 mm ²	2
33352055	TPA	1
13849267	Fastener M5	1

DIMENSION MEASUREMENT SAMPLE

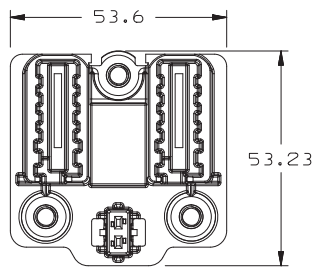

33346375

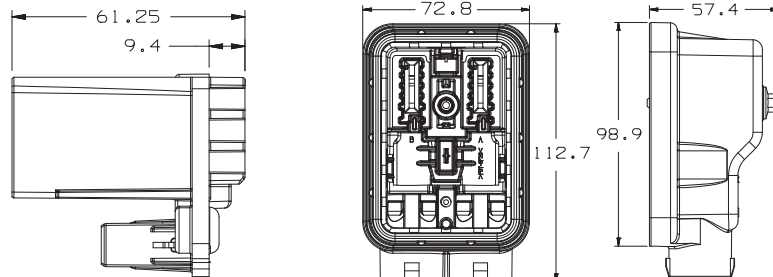

33352038



HV AK PASS-THROUGH

AK



BENEFITS

- Very compact dimensions
- High robustness against vibrations
- Higher operating temperatures

FEATURES

- Ring terminal is bolted to device
- Cables are 360° individually shielded
- High voltage panel mount system
- Fully interchangeable with other AK supplier sources

APPLICATIONS

AC / DC inverter

HV battery

HV PDU

Power electric box

E-motor

AVAILABLE CONFIGURATIONS

Connector Type	Pass-through
Cable Exit Orientation	180°
Cable Range (mm²)	16 - 50 (power)
Terminal Type	O-ring
Shielding	Individual
HVIL	None

PERFORMANCE

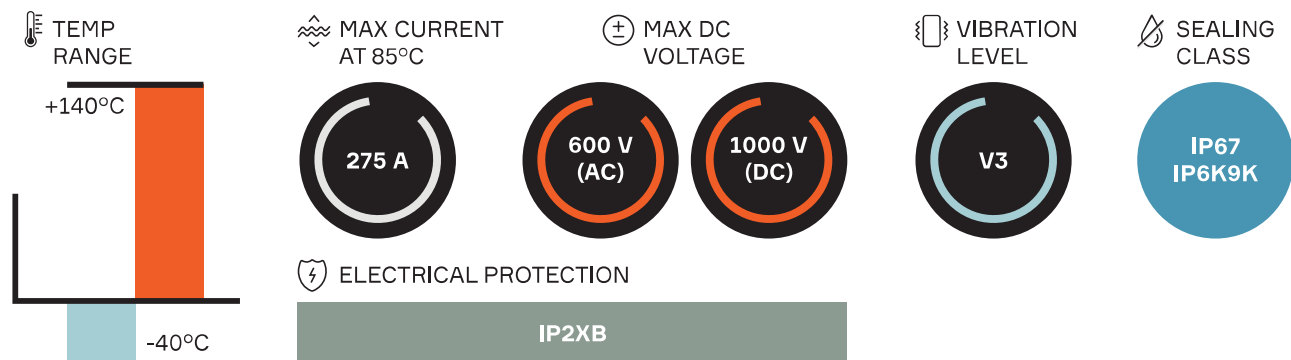

Main Housing Body Components

Code	Number of ways			BOM
	1	2	3	
A	33340524	33340525	33340526	1
B	35066699	-	-	

ASSOCIATED PARTS

Description	Cable size				BOM*
	16 mm ²	25 mm ²	35 mm ²	50 mm ²	
Peripheral seal	35116341				1, 2 or 3
Inner ferrule	35172747				1, 2 or 3
Outer ferrule	33340554	35172745	35172743	33340551	1, 2 or 3
Single wire seal	33340537	35172739	35172738	33340534	1, 2 or 3
Cable strain relief	33340542	33340541	33340540	33340539	1, 2 or 3

* Depending on if the component is for 1, 2 or 3 Way pass-through.

Component Kits**

Code	Cable size				BOM
	16 mm²	25 mm²	35 mm²	50 mm²	
1 Way					
A	33350177	33350176	33350175	33349598	1
B	-	-	-	35083309	1
2 Way					
A	33350180	33350179	3335178	33349600	2
3 Way					
A	33350183	33350182	33350181	33350072	3

** Available configurations with associated BOM (Bill Of Materials).

DIMENSION MEASUREMENT SAMPLE

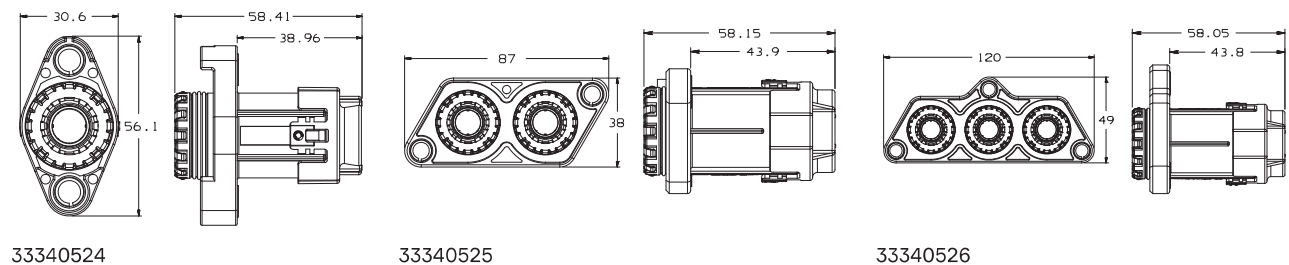

HV METAL PASS-THROUGH



BENEFITS

- Robust design for harsh environments
- Very compact dimensions
- Wide variety of indexes depending on wire sections

FEATURES

- High voltage panel mount system
- 1 Way sealed and shielded solution
- Ring terminal bolted to device

APPLICATIONS

AC / DC inverter

HV battery

HV PDU

Power electric box

E-motor

AVAILABLE CONFIGURATIONS

Connector Type	Pass-through
Cable Exit Orientation	180°
Cable Range (mm²)	25 - 50 (power)
Terminal Type	Ring
# of Power Terminals	1
Shielding	Individual
HVIL	None
Number of Indexes	6-8, depending on wire section

PERFORMANCE

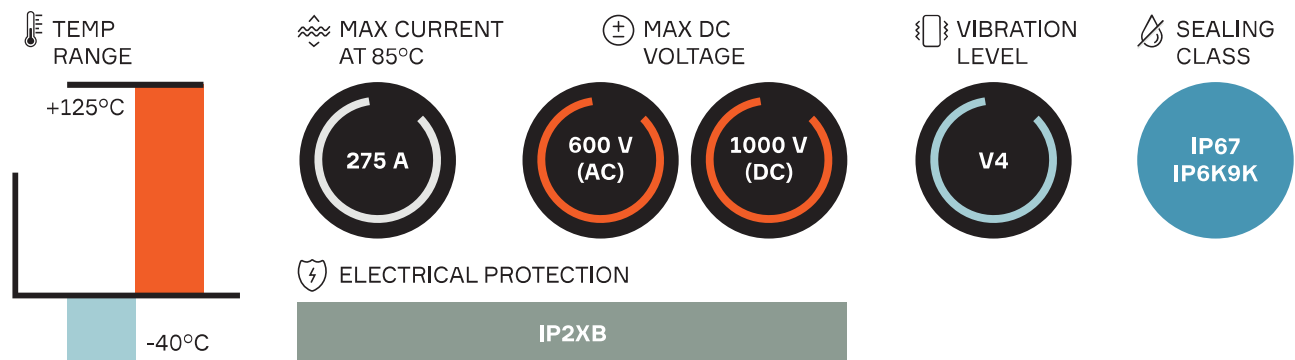

Main Housing Body Components

Index	25 mm ² wire section	35 mm ² wire section	50 mm ² wire section	BOM
102	13888001	13894189	33112598	1
103	13888002	13894190	33112599	
104	13888003	13894191	33112600	
105	13888004	13894192	33112601	
106	-	-	33112602	
107	-	-	33112608	
108	33253253	33253255	33112609	
109	33253254	33253256	33112610	

ASSOCIATED PARTS

Part number	Description	Part number	Description	Part number	Description
25 mm²		35 mm²		50 mm²	
13888023	25 mm ² seal retainer	13894241	35 mm ² seal retainer	33112613	50 mm ² seal retainer
13888030	25 mm ² seal	33288396	35 mm ² seal	33112616	50 mm ² seal
13888025	O-ring seal	13888025	O-ring seal	13888025	O-ring seal
33295901	25 mm ² ferrule	33295902	35 mm ² ferrule	33295903	50 mm ² ferrule

DIMENSION MEASUREMENT SAMPLE

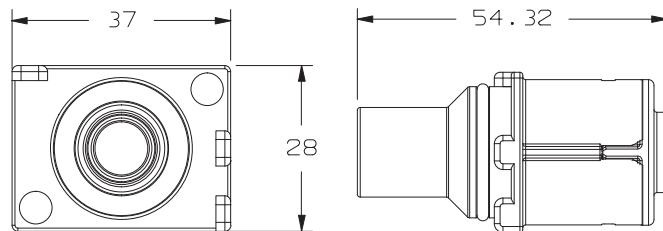

13888001