

Wireless set - FL WLAN 4321 - 1194423

Please be informed that the data shown in this PDF Document is generated from our Online Catalog. Please find the complete data in the user's documentation. Our General Terms of Use for Downloads are valid (<http://phoenixcontact.com/download>)



Pre-configured point-to-point Ethernet bridge kit for USA and Canada with internal antennas for pole mounting (outer dimensions 0.25 in. to 2 in.). IP67, wireless Ethernet communication up to 300 Mbps, frequency: 2.4 GHz, 10/100/1000 Mbps RJ45, passive PoE (8-30VDC) powered.

Key Commercial Data

Packing unit	1 pc
Weight per Piece (excluding packing)	2,380.000 g
Country of origin	Poland

Technical data

Dimensions

Width	185 mm
Height	63.5 mm
Depth	185 mm
Note on dimensions	Outside dimensions

Ambient conditions

Ambient temperature (operation)	-40 °C ... 75 °C
Ambient temperature (storage/transport)	-45 °C ... 85 °C
Permissible humidity (operation)	5 % ... 95 % (non-condensing)
Permissible humidity (storage/transport)	5 % ... 95 % (non-condensing)
Degree of protection	IP67

Wireless interface

Designation	Wireless LAN
Antenna connection method	(Internal)
Wireless standard	IEEE 802.11 (Wi-Fi Alliance)
	b (Wi-Fi 1)
	g (Wi-Fi 3)
	n (Wi-Fi 4)
Frequency band	2.4 GHz

Wireless set - FL WLAN 4321 - 1194423

Technical data

Wireless interface

Number of wireless interfaces	1 IEEE 802.11 b/g/n
Wireless modules that can be connected	1 ()

Functions

Security	256-bit AES-CCM Encryption
	WPA2

Wireless card

Number	1
Type	IEEE 802.11 b/g/n 2.4 GHz to 300 Mbps
Assembly instructions	Permanently installed

Antenna

Assembly instructions	Internal antenna
Number	1
Connection method	permanently installed
Note on the connection method	Dual polarized: Horizontal and vertical
Gain	11 dBi

Ethernet interface

Interface	Ethernet (RJ45)
Number of interfaces	1
Connection method	RJ45
Note on the connection method	Auto negotiation and autocrossing
Transmission speed	10/100/1000 Mbps
Transmission physics	Copper

Power supply for module electronics

Supply voltage	120 V AC (converted to 24 V DC via passive POE adapter (included))
----------------	--

General

Housing material	Polystyrene
Color	white
Net weight	2400 g
Wireless licenses	USA, Canada
Wireless licences	USA
	Canada

Standards and Regulations

Standards/regulations	FCC Part 15B
Test result	Class A

Wireless set - FL WLAN 4321 - 1194423

Drawings

Dimensional drawing

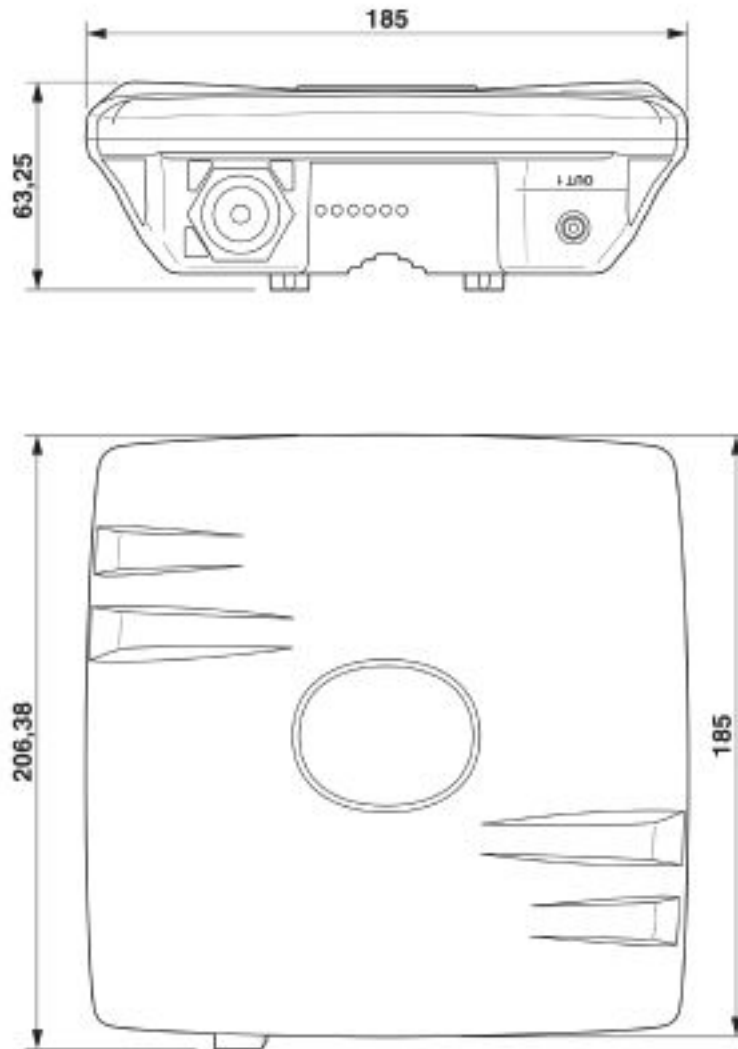

Wireless set - FL WLAN 4321 - 1194423

Application drawing

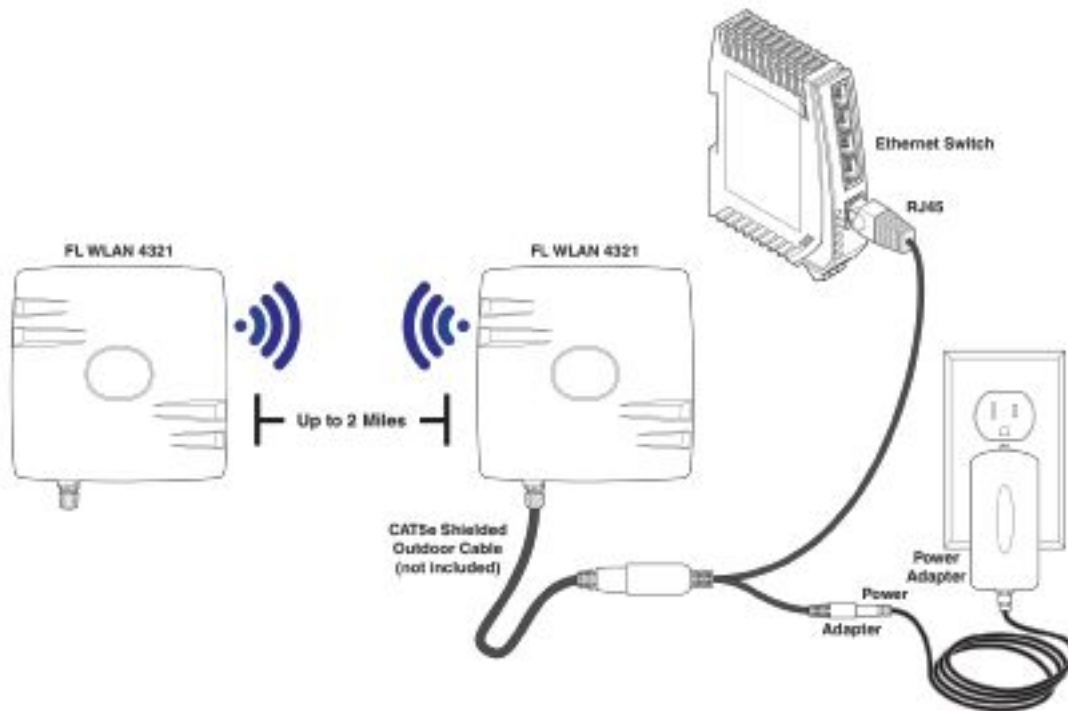

Accessories

Accessories

Data cable preassembled

Network cable - NBC-R4AC-IE8/.../... - 1411838



Network cable, degree of protection: IP20, number of positions: 8, 1 Gbps, CAT5, cable outlet: straight

Patch panel

Patch panels - PP-RJ-SC - 2703016



Patch panel, RJ45 jack on screw terminal blocks, 10/100/1000 Mbps, DIN rail adapter, IP20, shield contacting with strain relief

Wireless set - FL WLAN 4321 - 1194423

Accessories

Patch panels - PP-RJ-SCC - 2703018



Patch panel, RJ45 jack on Push-in terminal blocks, 10/100/1000 Mbps, DIN rail adapter, IP20, shield contacting with strain relief

Patch panels - PP-RJ-IDC - 2703019



Patch panel, RJ45 jack on IDC terminal blocks, 10/100/1000 Mbps, DIN rail adapter, IP20, shield contacting with strain relief

Power supply

Power supply unit - UNO-PS/1AC/24DC/ 30W - 2902991



Primary-switched UNO POWER power supply for DIN rail mounting, input: 1-phase, output: 24 V DC/30 W

Switch

Industrial Ethernet Switch - FL SWITCH 1005N - 1085039



Narrow Ethernet switch, five RJ45 ports with 10/100 Mbps on all ports, automatic data transmission speed detection, autocrossing function, and QoS

Wireless set - FL WLAN 4321 - 1194423

Accessories

Industrial Ethernet Switch - FL SWITCH 1008N - 1085256



Narrow Ethernet switch, eight RJ45 ports with 10/100 Mbps on all ports, automatic data transmission speed detection, autocrossing function, and QoS

NBC-R4AQ/25,0-94D/OE - 1211706

NBC-R4AQ/50,0-94D/OE - 1211705
