



# HV RCS 890 SERIES

FOR NEW DESIGN, CONSIDER THE NEW HV 890 RV SERIES



## BENEFITS

- Easy to assemble with integrated ErgoMate™ Axial Mating Assist System on harness connector
- Compact package with unique integrated electric interlock
- Header is sealed in both mated and unmated position

## FEATURES

- Bundle shielding with external braid
- Panel mount to device with face seal to module
- Two-stage disconnect for safe unmating

## APPLICATIONS

AC / DC inverter

DC / DC converter

HV battery

Power electric box

HV PDU

## AVAILABLE CONFIGURATIONS

Connector Type	Wire-to-device
Cable Exit Orientation	90°
Cable Range (mm <sup>2</sup> )	35 - 50 (power) 0.5 - 0.75 (HVIL)
Terminal Type	8 mm round contact system
# of Power Terminals	2
Shielding	Bundle
HVIL	Shunt on female
Assembly Assurance	CPA
Number of Indexes	1

## PERFORMANCE

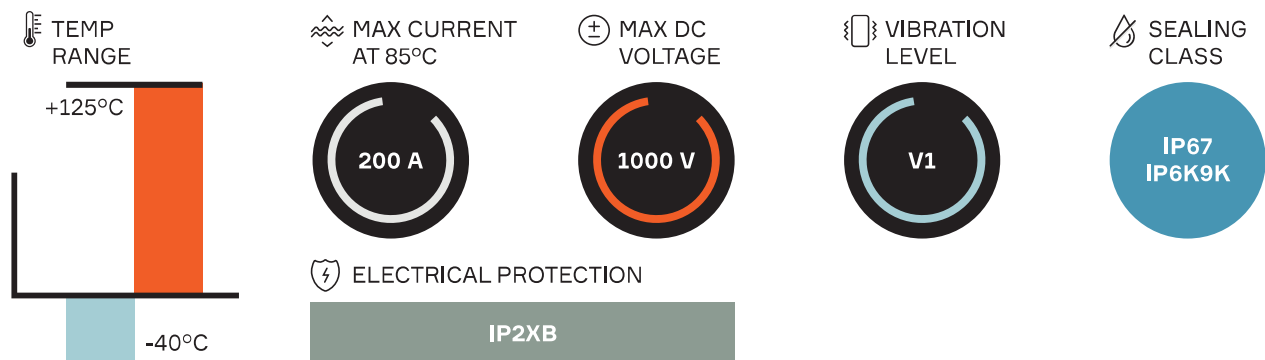

Header connector	Mating connector	BOM
33503821	33511750	1

## ASSOCIATED PARTS

Part number	Description	BOM
Header		
33512193	RCS 800/890 male pin terminal silver version standard length	2
33511746	RCS 800/890 male pin terminal silver version V1 length	
33511747	RCS 800/890 male pin terminal silver version V2 length	
10811962	DCS2 1.5 female terminal gold-plated 0.5 - 1.0 mm²	2
15441379	DCS/DSQ 1.5 red single wire seal 0.22 - 0.5 mm²	2
15441380	DCS/DSQ 1.5 grey single wire seal 0.75 - 1.0 mm²	
Mating Connector		
33511752	RCS 890 female terminal silver version 16 - 25 mm²	2
33502217	RCS 890 female terminal silver version 35 - 50 mm²	
35166051	RCS 890 female terminal silver version 70 mm²	
33521619	RCS 890 single wire seal & retainer 16-25 mm²	2
33511753	RCS 890 single wire seal & retainer 35 - 40 mm²	
33511754	RCS 890 single wire seal & retainer 50 mm²	
35199856	RCS 890 single wire seal & retainer 70 mm²	
33504038	RCS 890 2-way half clamp	2

## DIMENSION MEASUREMENT SAMPLE

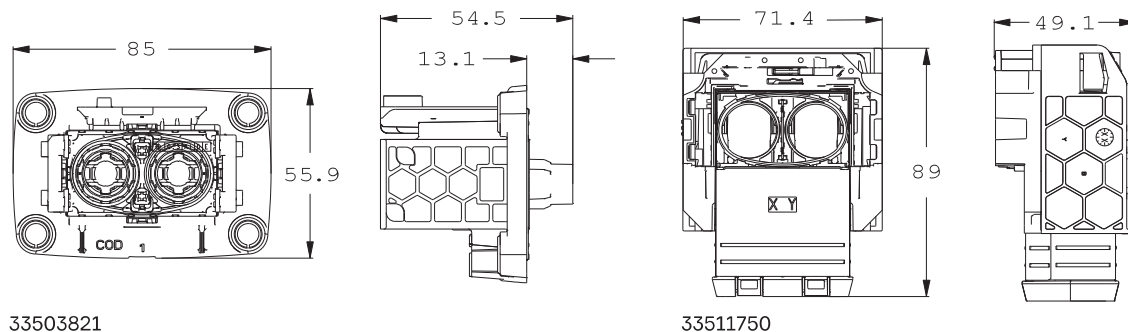

# HV RCS 890 RV 2 WAY SERIES

USE FOR NEW DESIGN



## BENEFITS

- Ultra compact design for applications with space constraints
- Panel mount to device with face seal to module
- Header is sealed in both mated and unmated position

## FEATURES

- Two-stage disconnect for safe unmating
- Easier mating with Slider Mating Assist System on harness connector
- Bundle shielding with external braid
- HVIL shunted in harness connector

## APPLICATIONS

AC / DC inverter

DC / DC converter

HV battery

Power electric box

HV PDU

## AVAILABLE CONFIGURATIONS

Connector Type	Wire-to-device
Cable Exit Orientation	90°
Cable Range (mm <sup>2</sup> )	16 - 70 (power) 0.35 - 1.0 (HVIL)
Terminal Type	8 mm round contact system
# of Power Terminals	2
Shielding	Bundle
HVIL	Shunt on female
Assembly Assurance	CPA
Number of Indexes	2

## PERFORMANCE

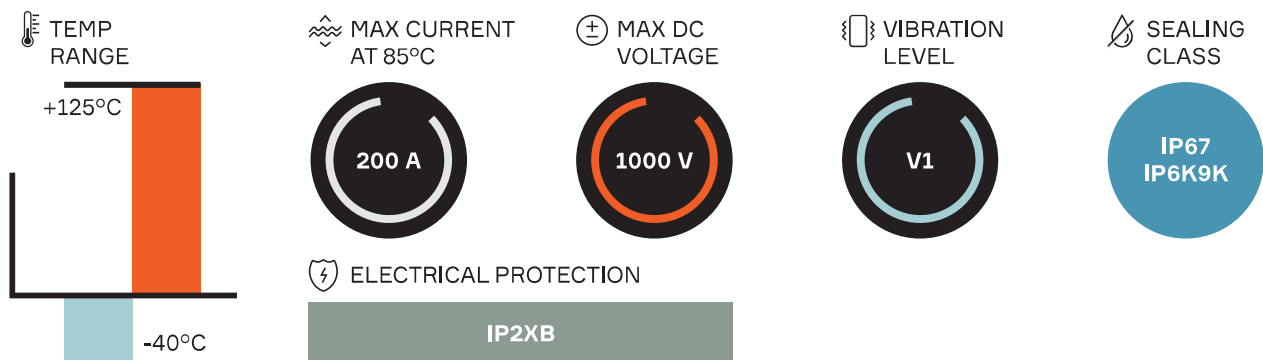

Index	Header connector	Mating connector	BOM
1	35326611	35092244	1
2	35326613	35092239	

## ASSOCIATED PARTS

Part number	Description	BOM
<b>Header</b>		
10811962	DCS2 1.5 female terminal gold-plated 0.5 - 1.0 mm <sup>2</sup>	2
15441379	DCS/DSQ 1.5 red single wire seal 0.35 - 0.5 mm <sup>2</sup>	2
15441380	DCS/DSQ 1.5 grey single wire seal 0.75 - 1.0 mm <sup>2</sup>	
33273083	RCS 800 male bus bar terminal silver version polarized pin	2
<b>Mating Connector</b>		
33511752	RCS 890 female terminal silver version 16 - 25 mm <sup>2</sup>	2
33502217	RCS 890 female terminal silver version 35 - 50 mm <sup>2</sup>	
35166051	RCS 890 female terminal silver version 70 mm <sup>2</sup>	
33521619	RCS 890 single wire seal & retainer (plug) 16 - 25 mm <sup>2</sup>	2
33511753	RCS 890 2-way female single wire seal & retainer (plug) 35 - 40 mm <sup>2</sup>	
33511754	RCS 890 2-way female single wire seal & retainer (plug) 50 mm <sup>2</sup>	
35199856	RCS 890 2-way female single wire seal & retainer (plug) 70 mm <sup>2</sup>	
35091447	RCS 890 2-way half clamp	2

## DIMENSION MEASUREMENT SAMPLE

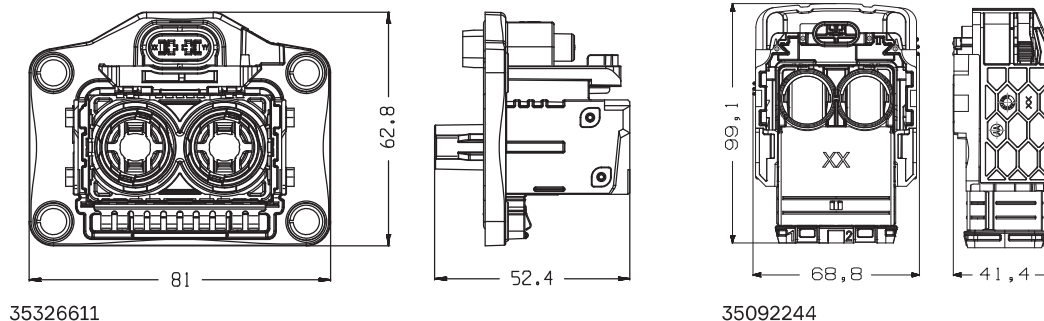

# HV RCS 890 RV 3 WAY SERIES



## BENEFITS

- Ultra compact design for applications with space constraints
- Panel mount to device with face seal to module
- Header is sealed in both mated and unmated position

## FEATURES

- Two-stage disconnect for safe unmating
- Easier mating with Slider Mating Assist System on harness connector
- Bundle shielding with external braid
- HVIL shunted in harness connector

## APPLICATIONS

AC / DC inverter  
DC / DC converter  
HV battery  
Power electric box  
HV PDU

## AVAILABLE CONFIGURATIONS

Connector Type	Wire-to-device
Cable Exit Orientation	90°
Cable Range (mm <sup>2</sup> )	16 - 70 (power) 0.5 - 0.75 (HVIL)
Terminal Type	8 mm round contact system
# of Power Terminals	3
Shielding	Bundle
HVIL	Shunt on female
Assembly Assurance	CPA
Number of Indexes	2

## PERFORMANCE

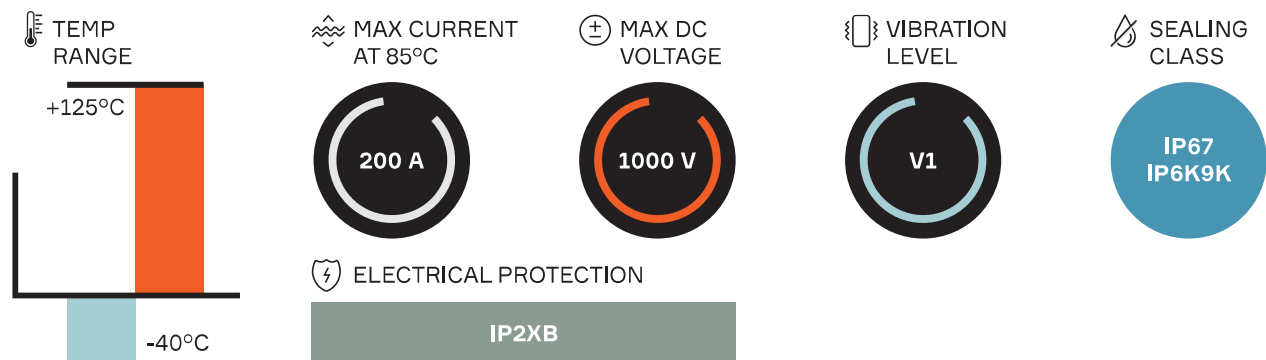

Index	Header connector	Mating connector	BOM
1	35310180	33272670	1
2	35310181	33282936	

## ASSOCIATED PARTS

Part number	Description	BOM
Header		
33273083	RCS 800 male bus bar terminal silver version polarized pin	3
10811962	DCS2 1.5 female terminal gold-plated 0.5 - 1.0 mm²	2
15441379	DCS/DSQ 1.5 red single wire seal 0.35 - 0.5 mm²	2
15441380	DCS/DSQ 1.5 grey single wire seal 0.75 - 1.0 mm²	
Mating Connector		
33511752	RCS 890 female terminal silver version 16 - 25 mm²	3
33502217	RCS 890 female terminal silver version 35 - 50 mm²	
35166051	RCS 890 female terminal silver version 70 mm²	
33521619	RCS 890 single wire seal & retainer 16 - 25 mm²	3
33511753	RCS 890 single wire seal & retainer 35 - 40 mm²	
33511754	RCS 890 single wire seal & retainer 50 mm²	
35199856	RCS 890 single wire seal & retainer 70 mm²	
33272561	RCS 890 3-way half clamp	2

## DIMENSION MEASUREMENT SAMPLE

